

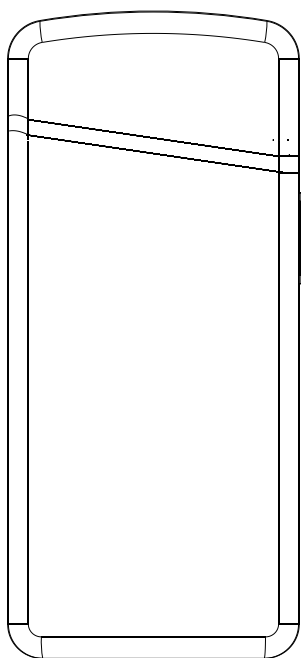

Version: S1700-1902



Windproof Arc Lighter

User manual

## USB Rechargeable Flameless Windproof Arc Lighter

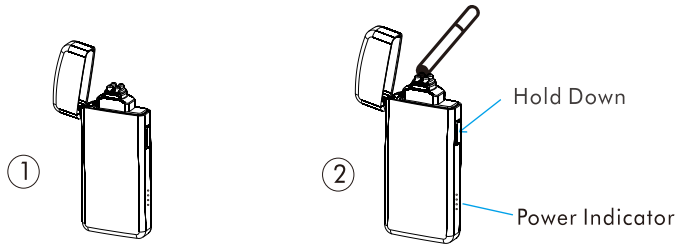

### Use

- 1) Open the lid, press the activation button and hold up the arc-flame to light;
- 2) Get the arc-flame close to objects you want to ignite, no need to directly touch on the electrodes.

\* If long press the activation button for over 10 seconds at one ignition time, the power will be cut off automatically for safety and prevent product from damage.

### Power Indicator

\*Battery indicator showing a status of power from high to low. That means you would never miss out a chance to light your life before it goes out! If only one lights on, please recharge it using the USB cable included.

## Charging

- 1) Before your first use, to ensure sufficient power please charge it for 1~2 hours;
- 2) In low power situation, you can charge it by using your USB charger, PC or Power bank, anyway, it is universal in charging.

## Warm-tip

[Keep your electrodes/contacts clean, we pack a small brush in box for your convenience.](#)

## Attention

1. Place the product out of the reach of children.
2. Do not contact the arc sparks with your fingers or metal to avoid any injury.
3. Do not place the product into water or other liquids, or it will cause a short circuit.
4. Please disconnect the power immediately after fully charged (2 - 3h fully charged), do not leave the arc lighter connected to the power source because overcharging will shorten the battery life.
5. When the battery is low power, the arc spark duration time shortens, at this time, please charge it. So please charge it before the battery is completely out of juice to extend the battery life.
6. Do not press the activation button for more than 10 seconds at a time to last the product's life.
7. Do not disassemble the arc lighter to avoid damaging the product or causing personal injury.

## Warranty

We offer 30-day money back and 18-month product warranty for defective replacement. Also you can register it for a 2-year extended warranty.

Scan QR code to View Warranty



Direct visit: <https://sipoe.com/register-product>

## Support

Email: [support@sipoe.com](mailto:support@sipoe.com)  
<https://sipoe.com/contact>



Join us at Facebook  
Enter: [m.me/sipoe.fans](https://m.me/sipoe.fans)